

X44

# UNIVERSAL INVISIBLE FRAME



DESIGN KIT

EN

## ■ INSTALLATION POSITION

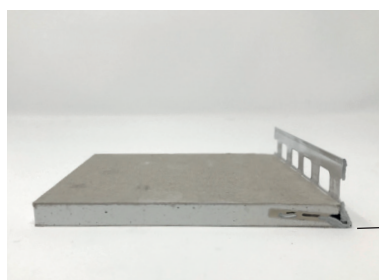
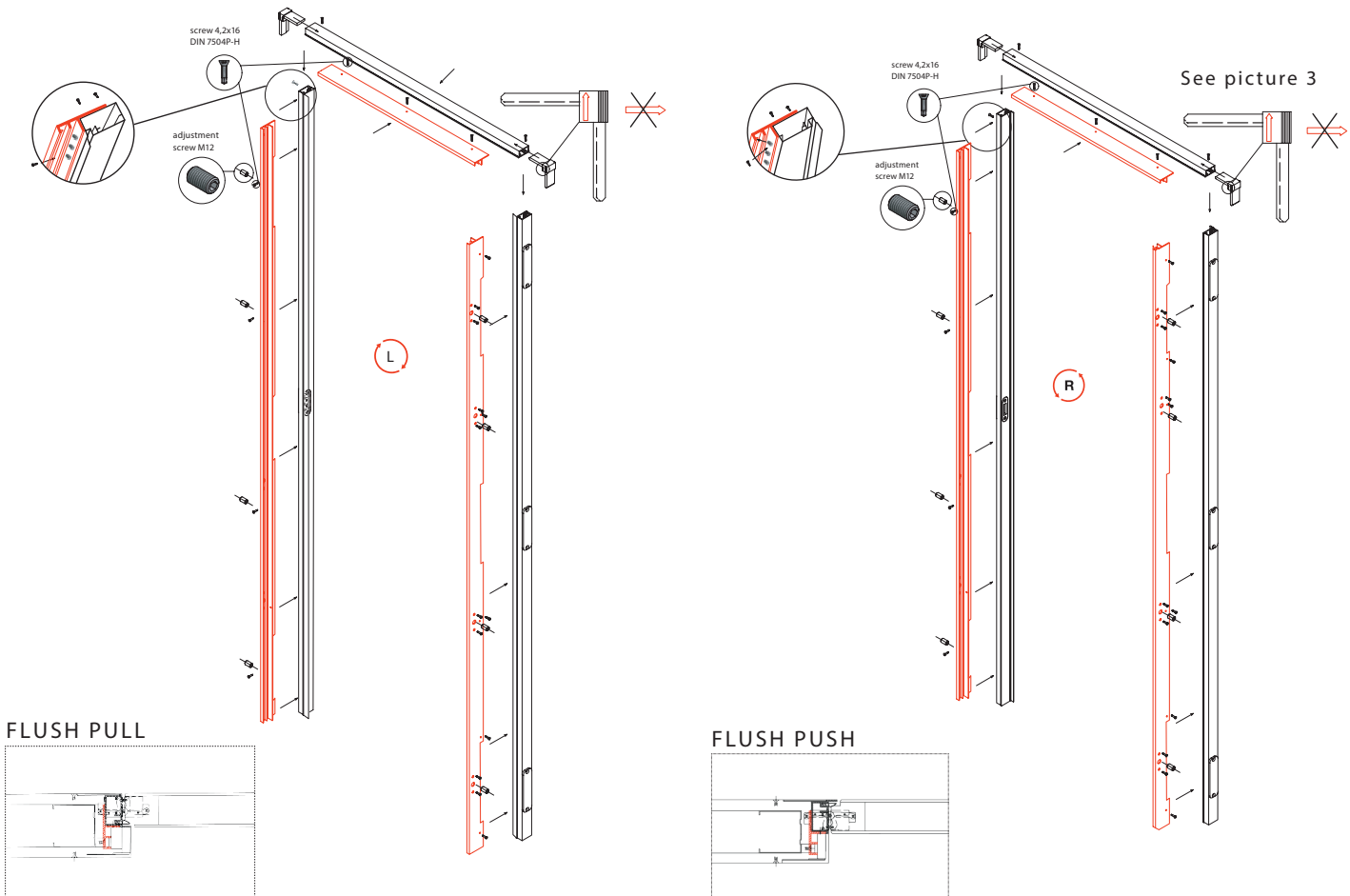

XA-FIN

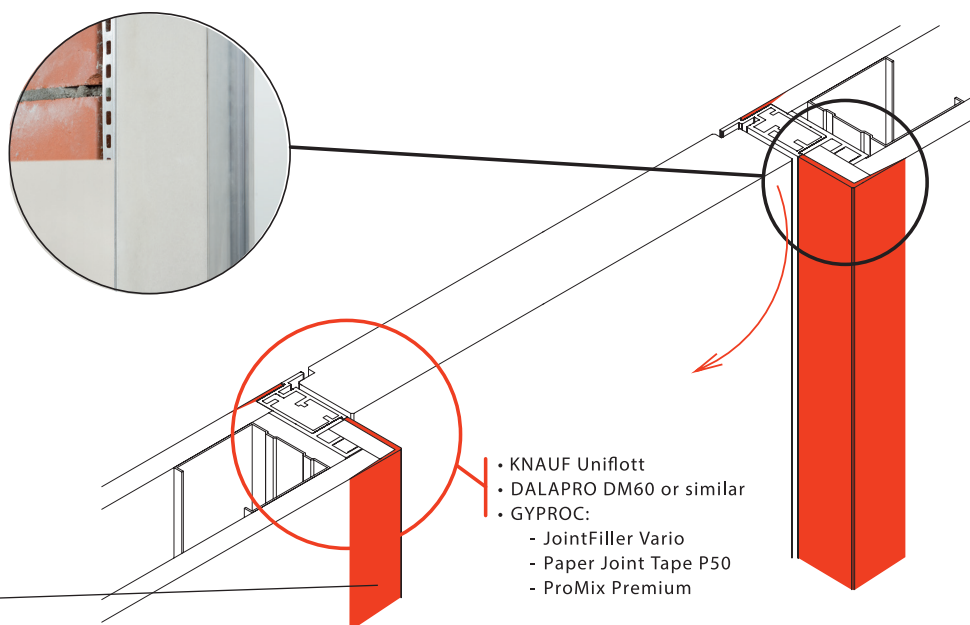

- KNAUF Uniflott
- DALAPRO DM60 or similar
- GYPROC:
  - JointFiller Vario
  - Paper Joint Tape P50
  - ProMix Premium

## ASSEMBLY OF THE SYSTEM



1 Place the elements around the door according to the direction of its rotation.



2 Attach the hinges to the door and the system.

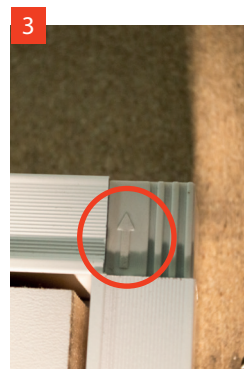

3 Click the corner of the upper rail into the side with the hinges. (arrow points upwards)



4 Click the corner of the upper rail into the lock side. Screw them into place.



5 Make sure you have 1/8" (3mm) ventilation at the top and bottom of the door.



6 The assembly is ready to be placed in the wall.

## INSTALLATION OF THE SYSTEM INTO THE WALL



1 The door + frame are ready to be placed into the wall.



2 Check if the door + frame are in alignment with the wall.



3 With adjusting screws you can level the frame.



4 Attach the frame to the wall with screws.



5 Fix with PUR foam.



6 Glue the brush in the middle of the upper rail.

## ■ DRILLING TEMPLATE FOR HANDLE HOLES OF THE MAGNETIC LOCK

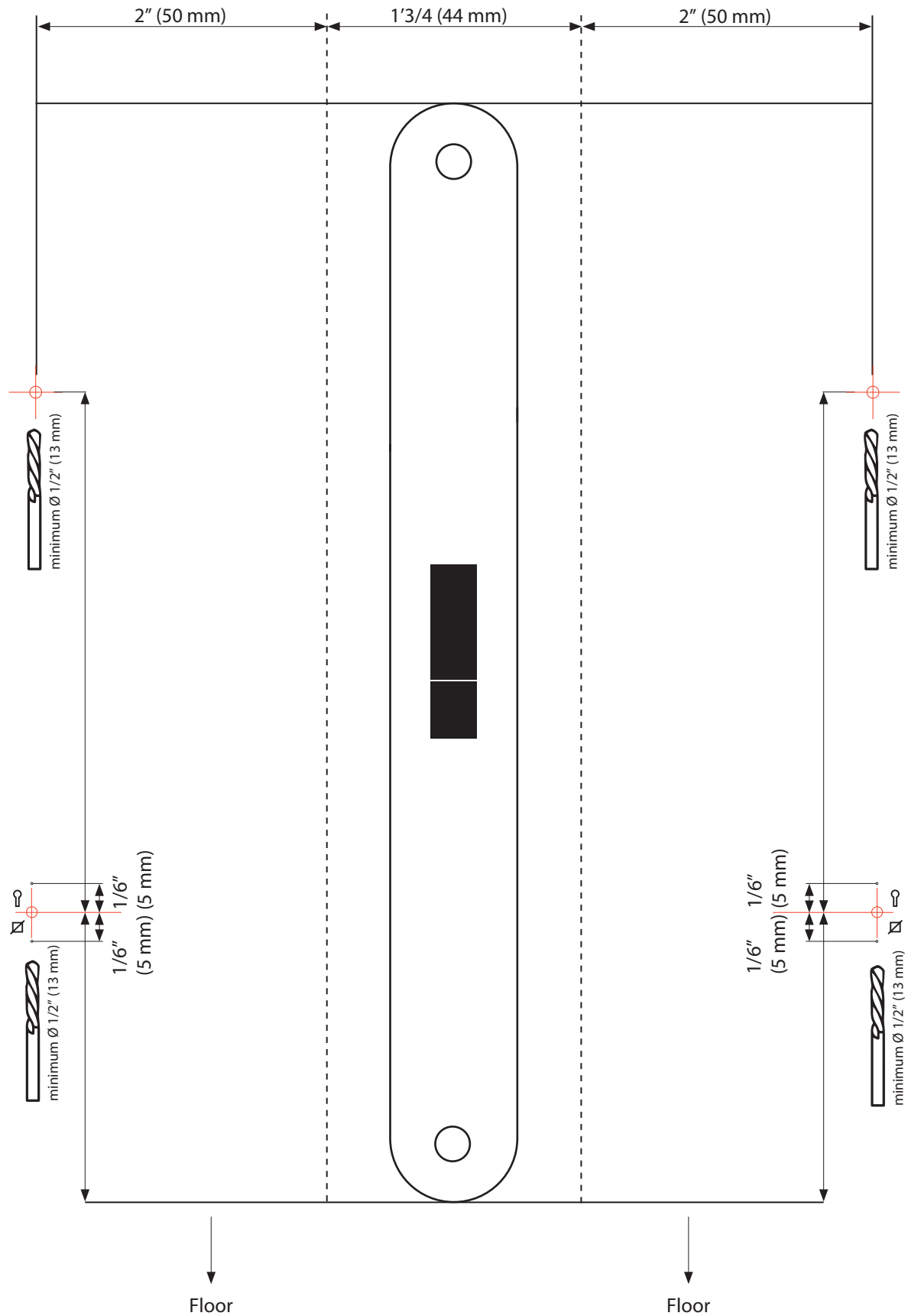



## ■ TECHNICAL INFORMATION

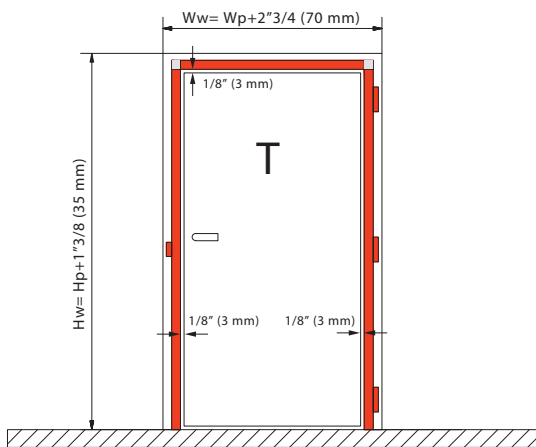

Hw: height opening

Ww: width opening

Hp: height door

Wp: width door

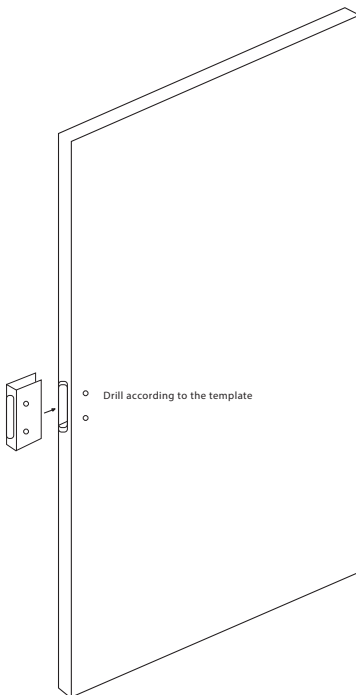

1. Determine the left/right direction of the rotation
2. Place the template
3. Determine the location of the drill holes
4. Remove the magnetic lock
5. Drill the holes
6. Remove the drilling chips
7. Install the magnetic lock correctly (see template)
8. Install the door handle
9. Place the door in the frameless system
10. Remove the clamping system on the latch bolt

PUSH

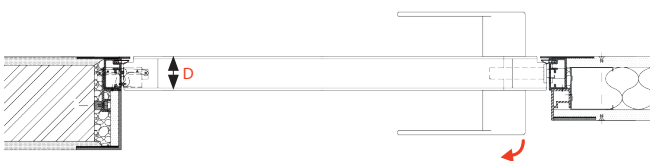

PULL

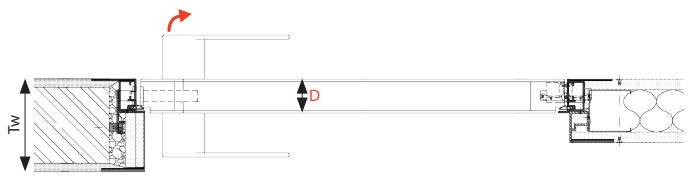

D=Door thickness	Tw=Total width wall
1 3/4 (44 mm)	Minimum 3" (70 mm)

■ FINISHING RECOMMENDATION

- For plasterboard walls, a paper jointing tape gives a better finish than a mesh tape.
- It is always recommended to apply primer to the aluminum profile in order to obtain a better finish.



Gyproc Placo	At the frontal flush side of the frame	At the non back flush side of the frame
Primer	Apply with a brush to the aluminum profile and leave to dry.	Only needed when the plasterboard doesn't reach completely up to the aluminum frame.
JointFiller Vario	Apply the first layer of Vario on the aluminum and the plasterboard plate. Produce mortar according to the guidelines on the packaging.	Apply the first layer of Vario on the aluminum and the plasterboard plate. Produce mortar according to the guidelines on the packaging.
Paper jointing tape	Push P50 Vario, squeeze out air underneath with a putty knife and iron the rest of the material onto the tape.	Only needed when the plasterboard doesn't reach completely up to the aluminum frame.
JointFiller Vario	Only needed when the plasterboard doesn't reach completely up to the aluminum frame. After the first layer of Vario has dried for at least 4 hours, apply the second layer of Vario due to excessive shrinkage in the opening.	Only needed when the plasterboard doesn't reach completely up to the aluminum frame.
ProMix Premium	1 layer of Promix Premium as finisher, preferably 24 hours after Vario. JointFiller Vario must be completely dry.	

DOOR HANDLES

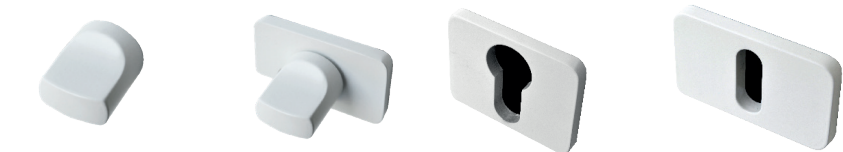

XA-A002WC.W      XA-A001WC.W      XA-A001PZ.W      XA-A001BB.W

INTEGRATED BASEBOARD SKIRTING  
POSSIBILITIES

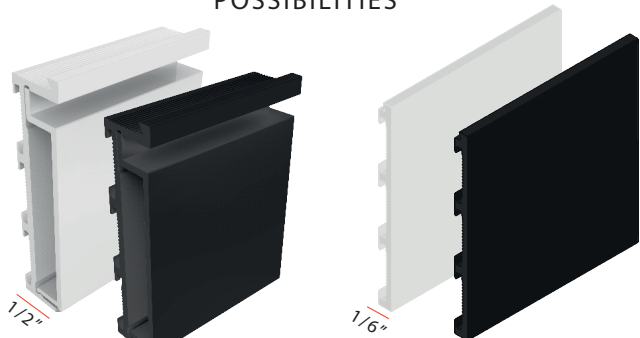

XP50-3000      XP50.04-3000